

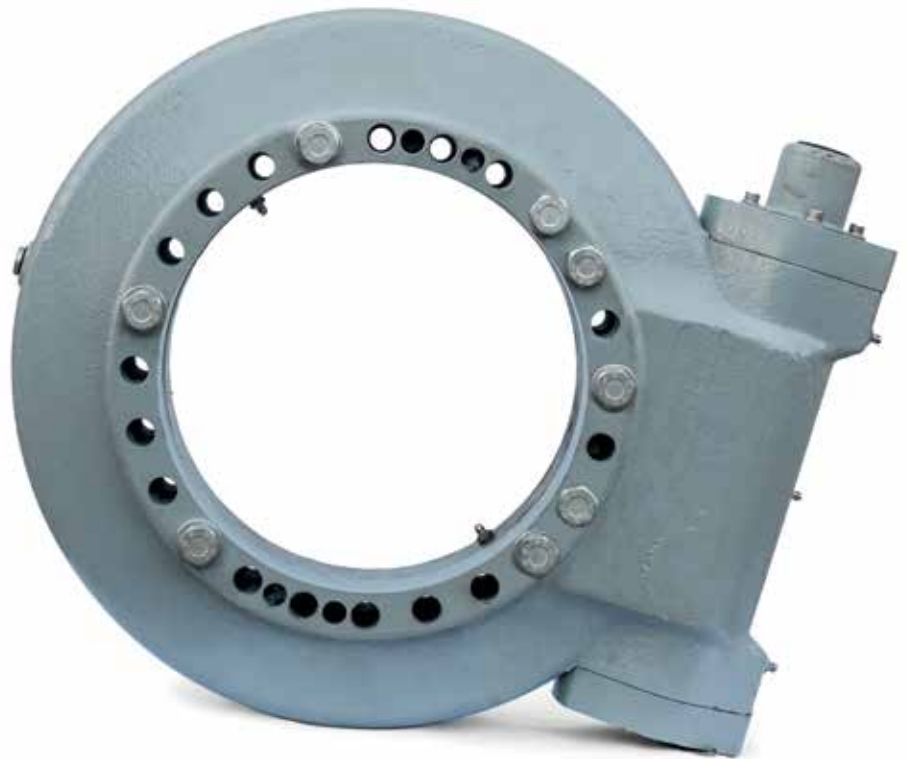

# Low Backlash Slew-ring

LBS is the low backlash slewing ring suited for high-precision solar tracking applications.

LBS is a compact construction with motor connection flanges for flexible and easy installation of its complementary sunto Waterproof Tracker Motor (WTM) that operates the rotational motion.



## Compact and robust high-precision rotation

- ✓ High precision with low backlash
- ✓ Rugged and enduring mechanics
- ✓ Long life performance
- ✓ UV resistant sealing
- ✓ Powder coating
- ✓ Easy installation and maintenance

### Applications

Solar tracking systems

- Single axis PV
- Dual-axis PV
- Concentration PV (CPV)
- High-concentration PV (HCPV)
- Solar-thermal installations

### LBS has been tested by

- Enel Ricerca e Innovazione